

Decorated Pots - Cricut Instructions

Setup

- **Note:** only one iPad per Cricut machine can be connected via Bluetooth at a time. Go to **Settings** on the iPad and confirm Bluetooth is turned **OFF**.
- When prompted, click Open Cricut Design Space.
- Click on green + circle to open a new project.

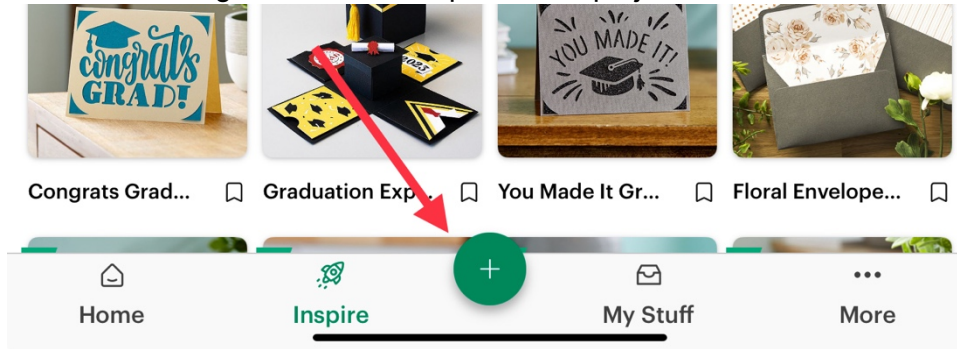

- This will take you to a blank canvas. Click **Upload** from the menu bar at the bottom, then **Open Uploaded Images**.

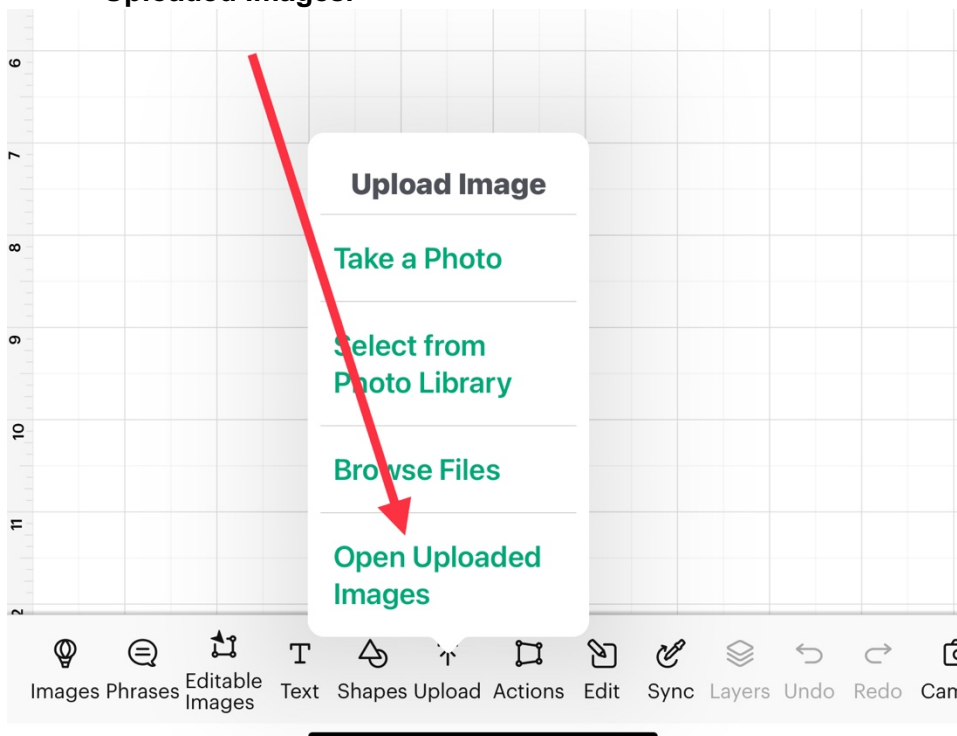

- Choose your design, click Add. Your design will appear on the canvas.

Customize

- Once DS and the selected image have loaded, click layers to Customize. Select the appropriate layer in that panel to customize a particular layer. If the layers are grouped, click the Ungroup icon at the bottom.

- Click Edit on the lock and change the W(width) and H(height) to determine the size in comparison to the size of your pot and how large you would like your design.

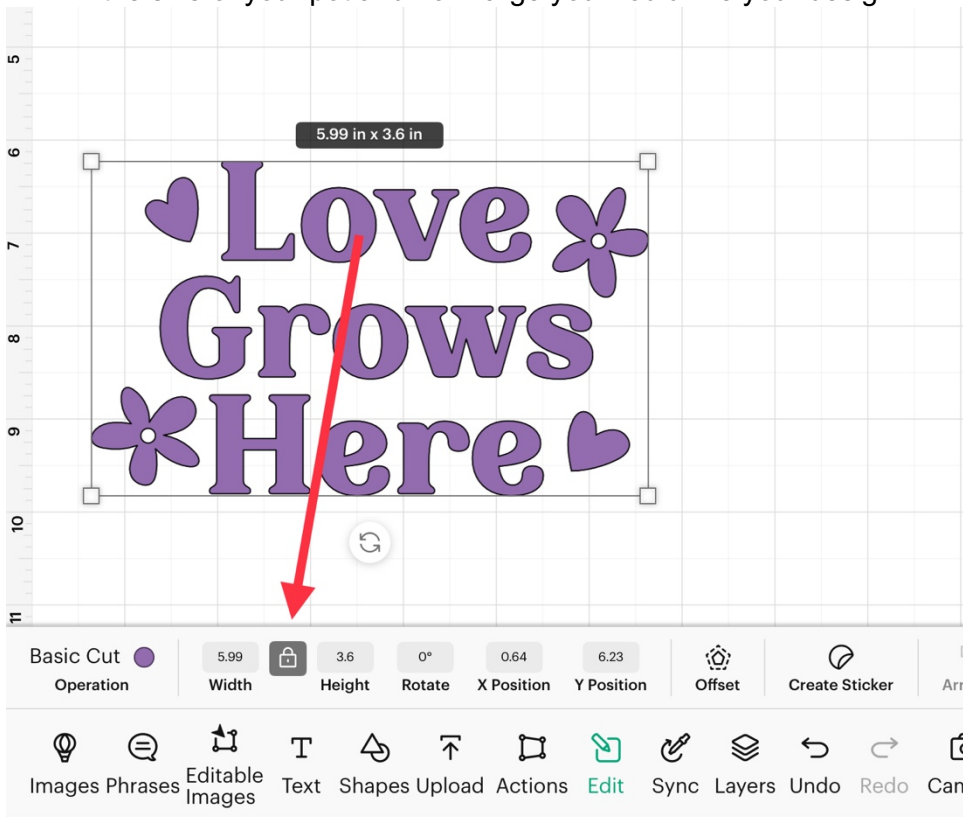

- Designs can be left as they are or add your own personalization. For personalization, click on Text icon, then click on the font name at the bottom. Use the filter, then under Status click the Free box.

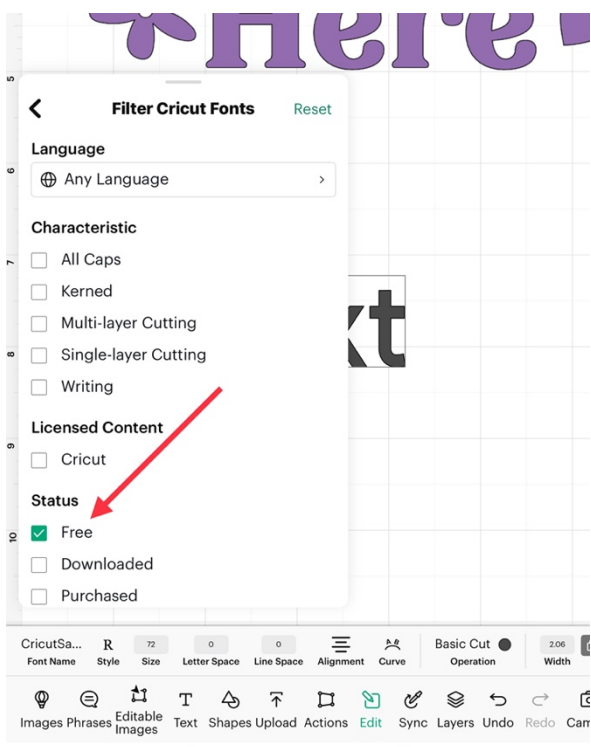

- Once you have clicked on the font, type in the Name or Initial you would like to use for personalization.

- Click and drag the name over the design, the text will be large so use the resize handle to adjust the name to fit on the circle.
- To align the design and text, on the layers panel highlight both by clicking on them and click **Align** and **Center** from the popup menu. Highlight all layers and attach by clicking the paper clip at the bottom of the layers panel. Check your sizing to make sure the entire group still fits nicely on the pot.
- Choose the color of the name you would like to cut, click on the name in the layers panel and the **Edit, Basic cut** to bring up color pallet, click **Apply**.
- Once completed with the design, **Hide** or **Delete** anything you don't want to cut.

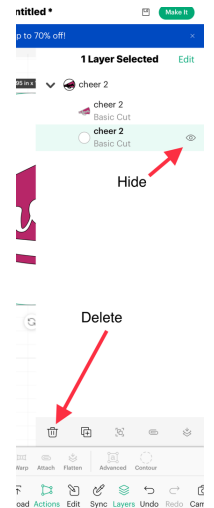

Cutting

- Go to Settings on the iPad, Bluetooth is turned ON.
- Once back in the design, click the green back button at the top left corner.

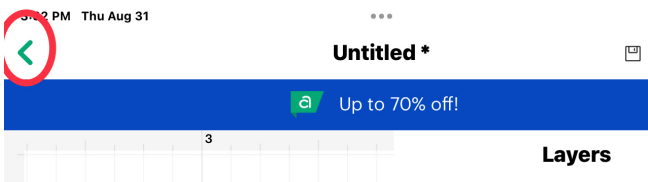

- Determine which machine is available to use and go to the menu bar and choose the appropriate machine: **Maker or Explore**.
- Click **Canvas** at the top right corner to return to your project.
- Click on **Make it** in the upper right corner.
- The top should show, **On Mat, Mirror Off**. Click **Next**.
- When done click **Next**.
- Set Base Material: Select **Premium Vinyl**.
- Place vinyl on machine mat with the pretty vinyl side facing up.
- Push the arrows to load the mat, slightly holding the mat guiding into the Cricut.
- Click the flashing button to cut.
- When your first mat is done, click the arrow buttons to unload and then load the next mat. Repeat the process until all of your colors are cut.

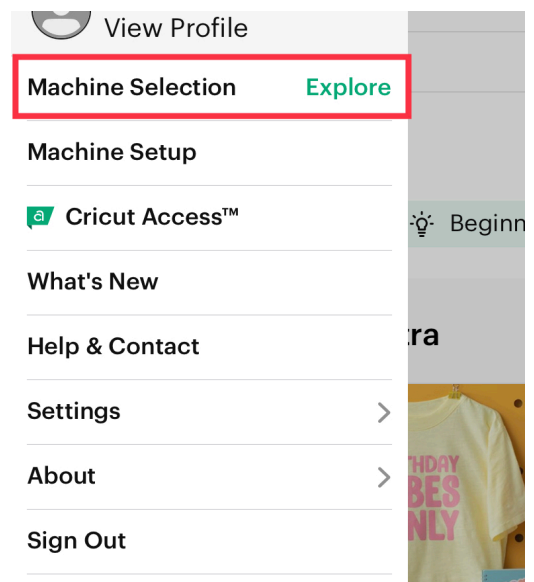

Weed and Apply Design

- With the weeding tool, gently remove all the excess vinyl from your design. Anything you do not want to transfer to the pot needs to be removed. Be patient with this process.
- Use a piece of transfer tape to match the size of your design.
- Peel the backing off the transfer tape and place the transfer tape on the vinyl.
- Press the transfer tape to the vinyl and peel away the vinyl backing.
- Adhere the design to the pot.
- Slowly peel away the transfer tape.

Congratulations! You now have a beautiful pot to take home and (hopefully) grow your choice of plants.