

Spring Tea Towels - Cricut Instructions

Preparing and Printing the Image

- Open Cricut Design Space
- Open a New Project

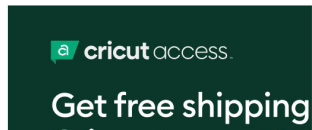

- Click **Upload** and Hello Spring SVG, **add to canvas**

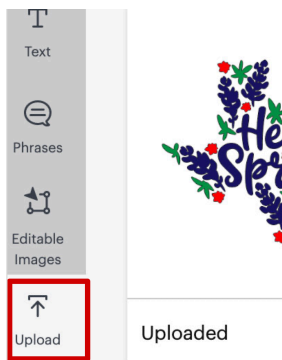

- Create an offset (you will only cut the offset, not the design itself)
 - Select the Image
 - Click **Offset**
 - Modify **Distance** to desired setting
 - Click **Apply**
 - Highlight offset on layers panel and change the color to white. (The offset layer automatically made the shadow layer black) Since the background of Cricut is white, click on blank canvas on the layers panel and at the top you can change the color of the canvas so the offset is easier to see.
 - On the layers panel, highlight both image and offset then click **flatten** which will make it all one layer. Otherwise the Cricut will cut each layer.



- Operation will show as a Print Then Cut
- Resize the image as desired
 - **SIZING RECOMMENDATION**
 - Divide the width of your tea towel by 3 (assuming when you hang the towel you'll fold it in thirds)
 - Subtract two inches from that (one inch margin on each side) and resize your image to the remainder
 - **EXAMPLE**
 - Tea Towel is 27" wide/3=9"
 - Subtract 2" for margins=7"
 - Resize your design to 6.75" (At this time, the largest size you can print an image is 9.25" x6.75". However, updates are made periodically. Make sure your image is not any larger.)
- Select the grouped images
- Enter 6.7 in the W (width) setting at the top of the screen and hit Enter (this will resize the entire selection to 6.7" wide or resize the image by dragging the corners inward or outward.

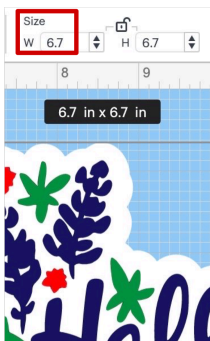

- Go to the top and press **Make It**
- Click **Mirror** button
- Press **Continue** at the bottom right
- Click on **Send to Printer**
 - You always want to click on Use System Dialogue. This will allow you to change printer settings.

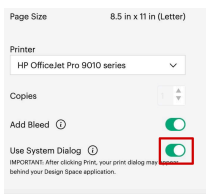

- Press **print**
 - Your system dialog box will be behind Design Space so you will need to move that out of the way
 - Change the quality slider from normal to best
 - Make sure you are printing in color
 - Press **print**
- Cutting the Image**
- Set your material on your Cricut machine to Printable Iron On, Light

- Place the printed material onto the mat aligning with the top left corner
- Load the mat into the machine by pressing the flashing **arrow key**
- Press the flashing **Cricut logo light**
- The Cricut will scan for the black registration marks outlining the image so it knows exactly where to cut around the image
- Flip it over, then peel the mat off the paper (separating the cut design from the excess) and not the paper off the mat because it may tear or curl.